



Ceramic Path Specification:

Model No.	GPS-02-1
Operating Frequency	T1 1575.42±1.023 MHz
Antenna Type	ROOF SCREW MOUNT
Output Impedance	50 ohms
Polarization	R.H.C.P.
Bandwidth	10 MHz min. @S11<=-10 dB
Gain at 10° elevation	-1 dBic Typ.
Axial Ratio	3.0 dB Typ.

LNA/Filter Specification:

Operating Frequency	T1 1575.42±1.023 MHz
Gain	28 Db Typ.
Noise Figure	1.5 Typ.
Filter	DR Filter
	20dB 30dB min @ fo±50MHz
	30dB 35dB min @ fo±50MHz
	* fo=1575.42 MHz

Output VSWR	2.0 Max
Voltage	2.3~5.5V
Current	2.5V : 6.6mA Typical
	3V : 8.6mA Typical
	4V : 12.6mA Typical
	5V : 16.6mA Typical

**General specification:**

Dimensions	L47xW50xH50 mm
Antenna Color	Black
Coaxial Cable	RG174 Length=3M (Option)
Cable Connector	SMA MALE (Option)
Operating Temperature	-30°C to +85°C
Storage Temperature	-40°C to +90°C

GPS-02-1

GPS ACTIVE 28dB 50mm CIRCLE ROOF SCREW MOUNT+RG174(3M)+SMA PLUG

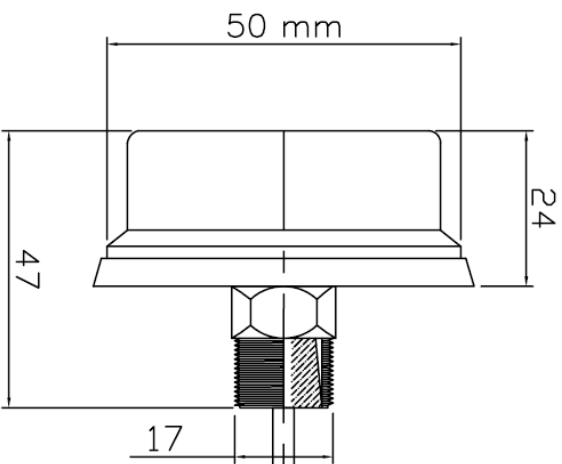
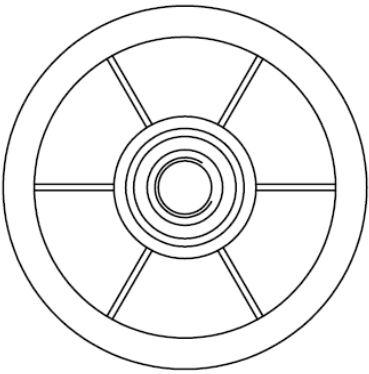

CABLE: RG174 Length=3M

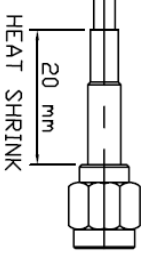

SMA MALE

1	FREQUENCY : 1757MHz	6	IMPEDANCE : 50Ω
2	GAIN : GPS ACTIVE 28dB	7	
3	V.S.W.R : <1.7	8	
4	CABLE LENGTH : RG174 L=3M (Option)	9	
5	CONNECTOR : SMA MALE (Option)	10	

