



850/900/1800/1900/2100MHz 2dBi 50mm CIRCLE ROOF SCREW+RG174(3M)+SMA MALE



Specifications/Special Features :
Global System for Mobile Communication
850/900/1800/1900/2100 MHz phone antenna,
Broadband design for GSM/UMTS/WCDMA systems.

Specification	
Model No.	GSM-06-6
Operating Frequency	850/900/1800/1900/2100 MHz
Antenna Type	Roof Screw Mount
Antenna Gain	2 dBi
Antenna Color	Black
VSWR	< 1.9
Polarization	Linear Vertical
Temperature	-40 to +85 °C
Humidity	40% to 95% RH
Connector Options	SMA MALE (Option)
Cable: RG-174	Length=3M (Option)
Cable Color	Black
Dimension	L47xW50xH50mm

GSM-06-6

GSM 850/900/1800/1900/2100 MHz 2dB_i 50mm CIRCLE ROOF SCREW+RG174(3M)+SMA MALE

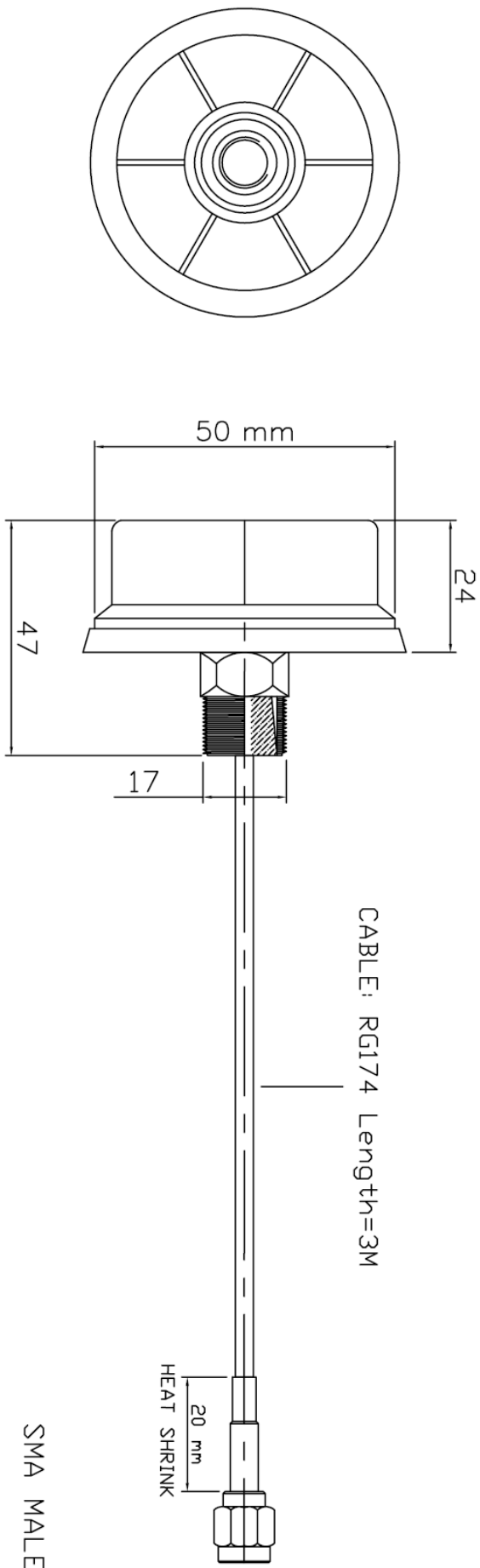

1	FREQUENCY : 850/900/1800/1900/2100 MHz	6	IMPEDANCE : 50Ω
2	GAIN : 2dB _i	7	
3	V.S.W/R : <1.9	8	
4	CABLE LENGTH : RG174 L=3M (Option)	9	
5	CONNECTOR : SMA MALE (Option)	10	

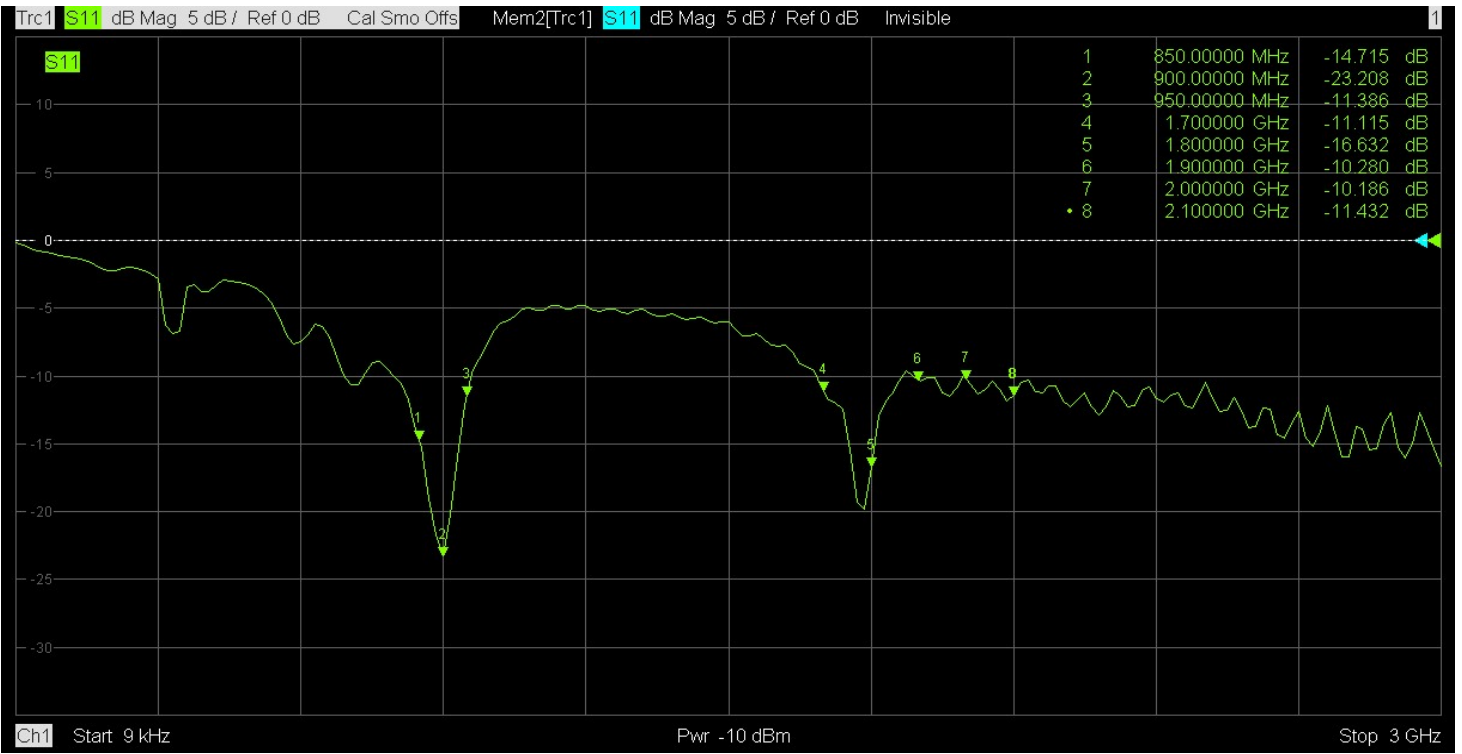

H-PLANE

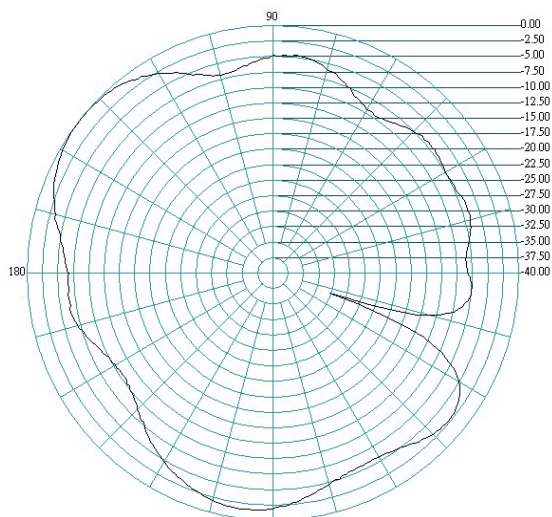

E-PLANE

